

Cetera 60'
Multispace Yacht
- Features in Detail -

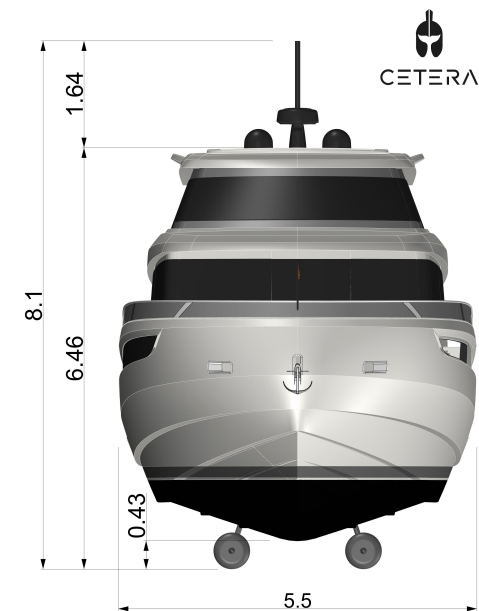

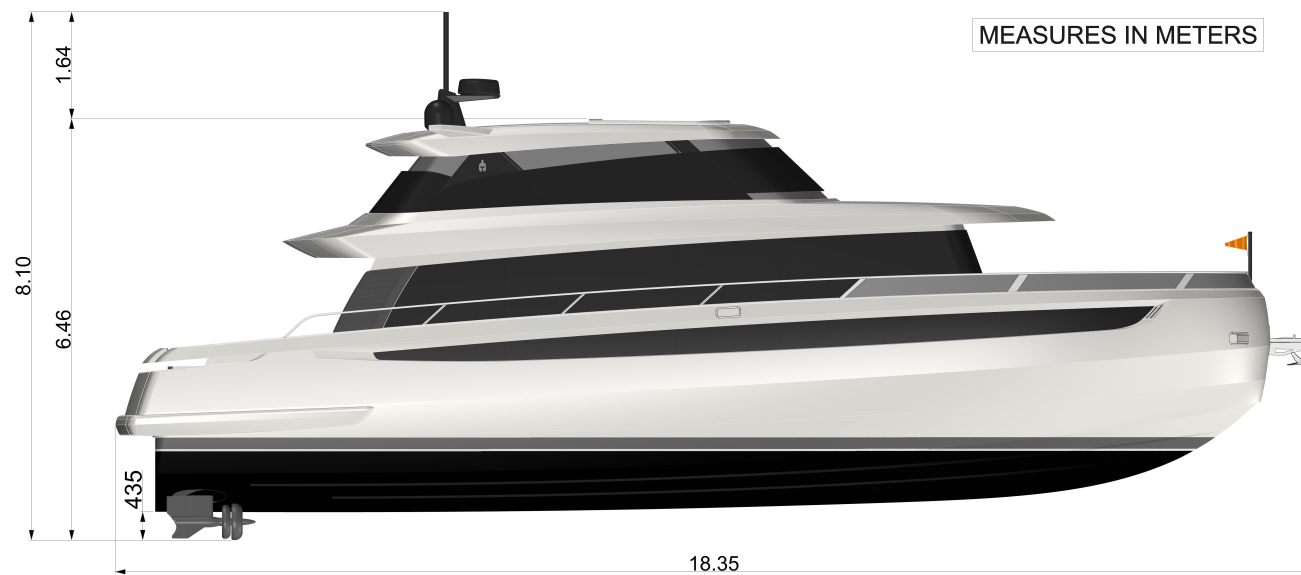

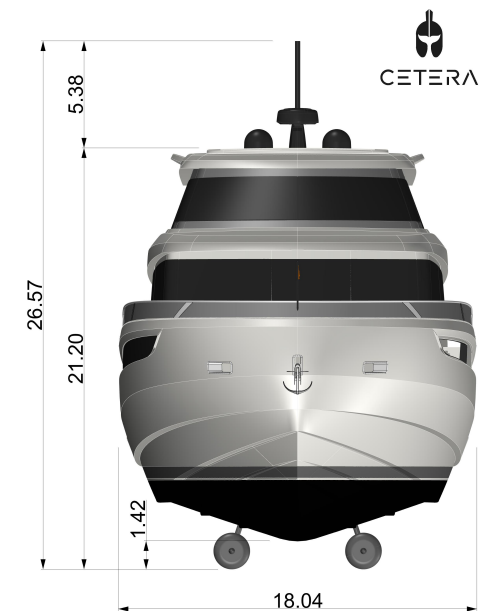

Second mooring station in the well :

There are joystick control and head maneuver propeller (bow thruster) controls in the second station located in the rear cockpit of the port side.

It offers very comfortable use especially when approaching the marina from the stern.



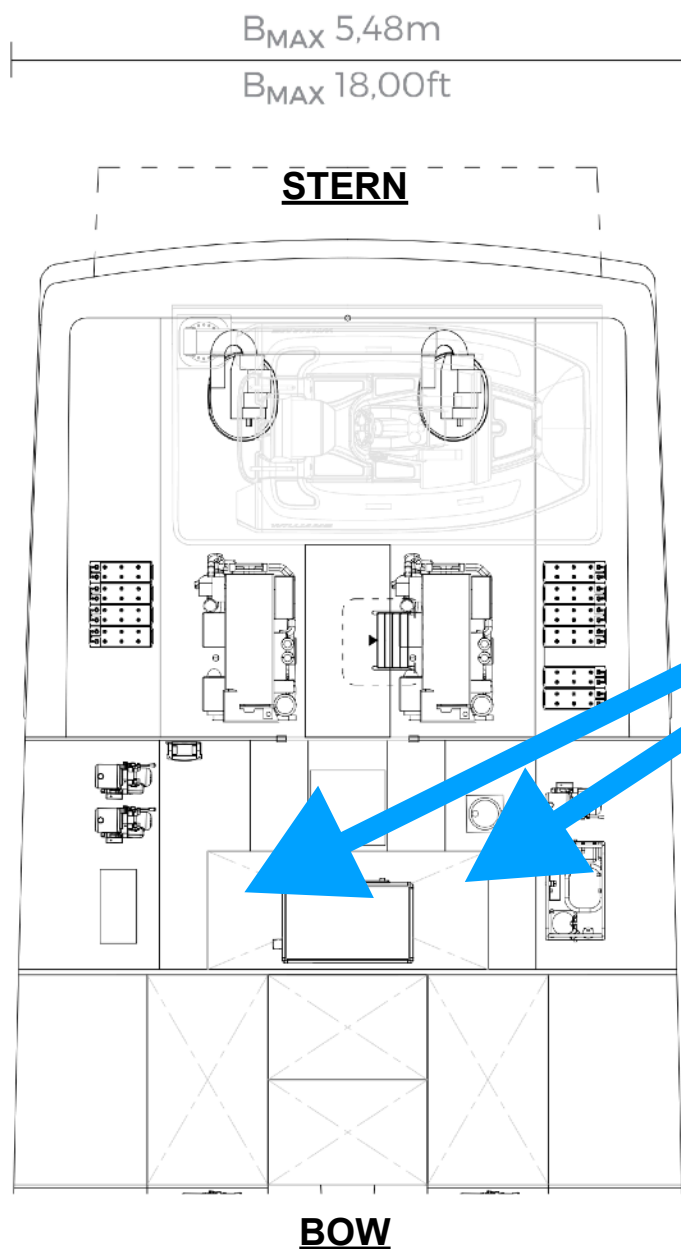

LOWER DECK



GYRO STABILIZER Quick x 16 (2 Sets) :

MC2 Quick Gyro stabilizers can reduce boat roll up to 95%, are very effective at speed as well as at anchor.

Gyro stabilizers offer unique features and are the result of careful research, aimed at achieving highly competitive performances and assuring maximum safety. With MC2 Quick Gyro on board, the comfort is guaranteed and you can enjoy all your special moments with rough sea too.

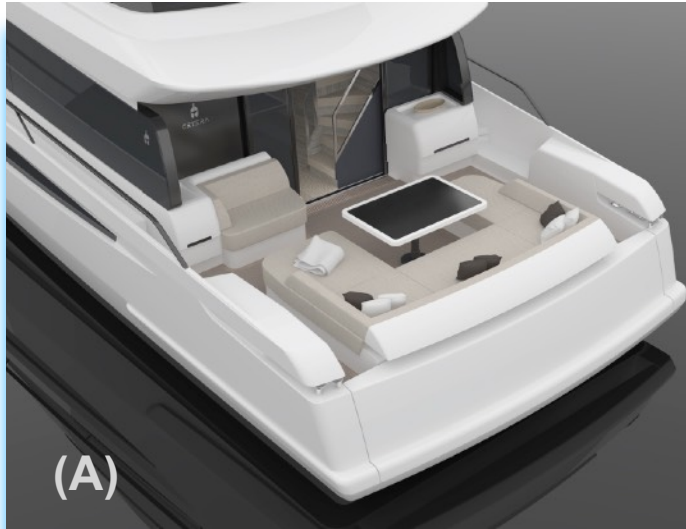

(A)

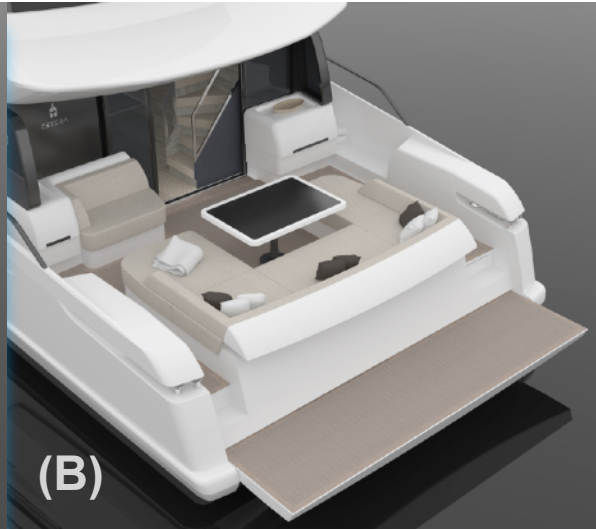

(B)

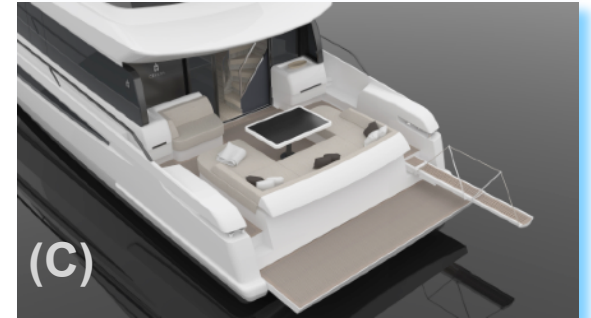

(C)

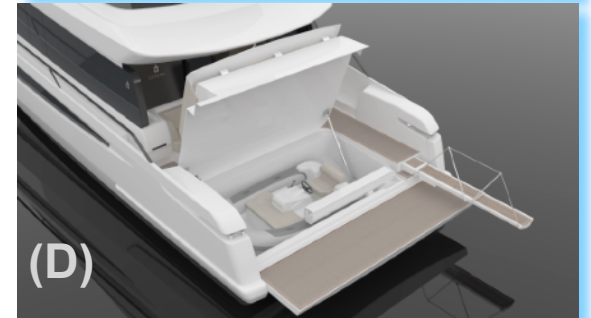

(D)

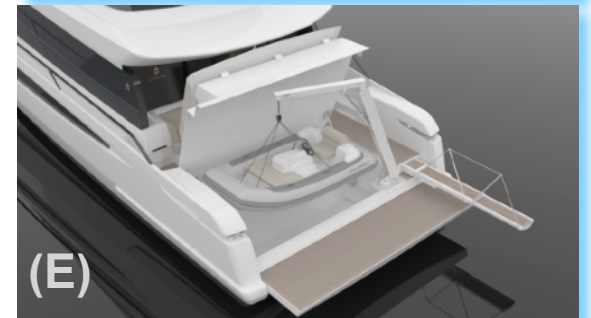

(E)

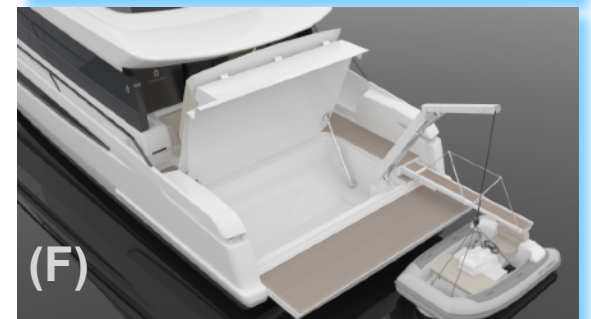

(F)

Swim Platform - Tender Garage - Retractable Gangway - Tender Winch :

Multi-purpose, practical, stylish, and comfortable solutions that facilitate sea life and cruising.

- (A) Cruising, swimming platform up
- (B) Anchorage or port, swimming platform down
- (C) Retractable gangway out for shore connection
- (D) Aft sofa (tender garage cover) up
- (E) Tender launching winch pick up the dingy
- (F) Dingy at sea with



**Front Deck &
Front Saloon**

(Main Deck)

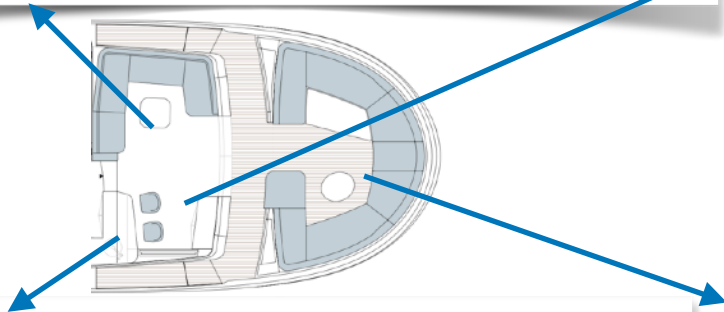



MIDSHIP
(Main Deck)

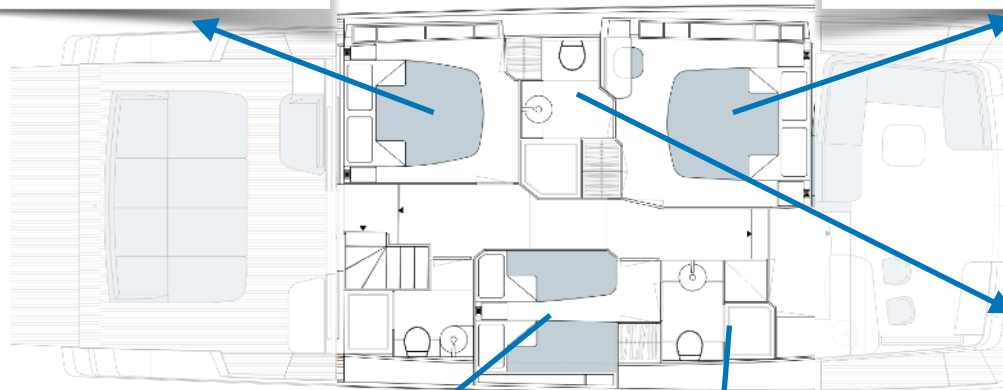

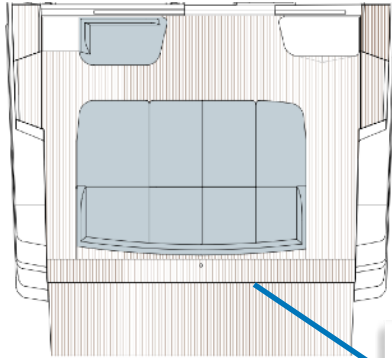

REAR DECK
(Main Deck)

AFT SIDE



LOWER DECK

Crew Cabin

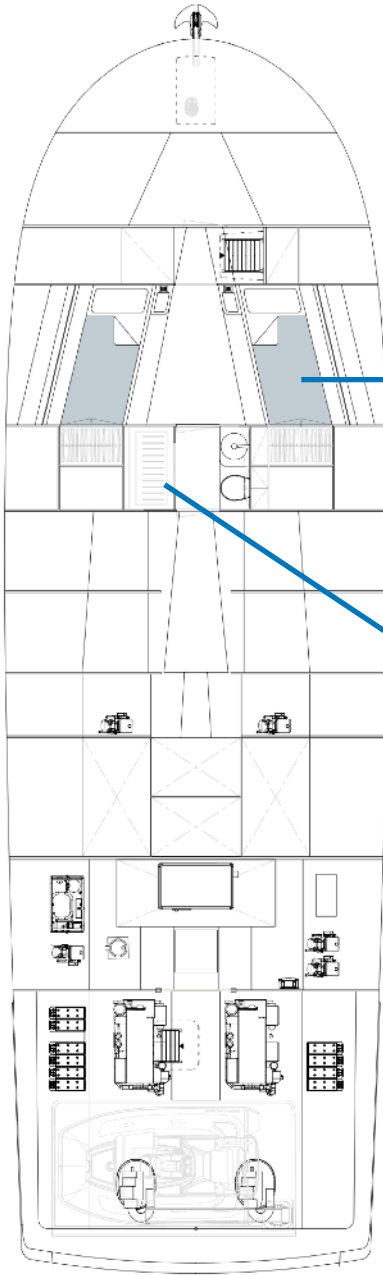



UPPER DECK

FlyBridge

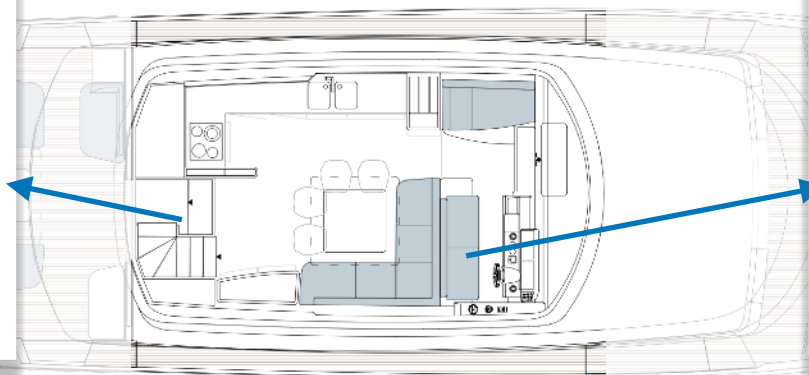





Made in ITALY



Exclusive Representative;

OGEM MARINE A.S.
Istanbul
www.ogemgroup.com

